

THIS DRAWING IS PROVIDED AS A GUIDELINE ONLY. IT IS THE GUNSMITH'S RESPONSIBILITY TO VERIFY ALL ACTION DIMENSIONS PRIOR TO BARREL INSTALLATION.

Tennon length only valid when using included surface-ground .250" Curtis Custom recoil lug.  
Use of other lugs will require altering of these dimensions.

Chamber chamfer  
Approx .010"x30°



DETAIL B  
SCALE 4:1

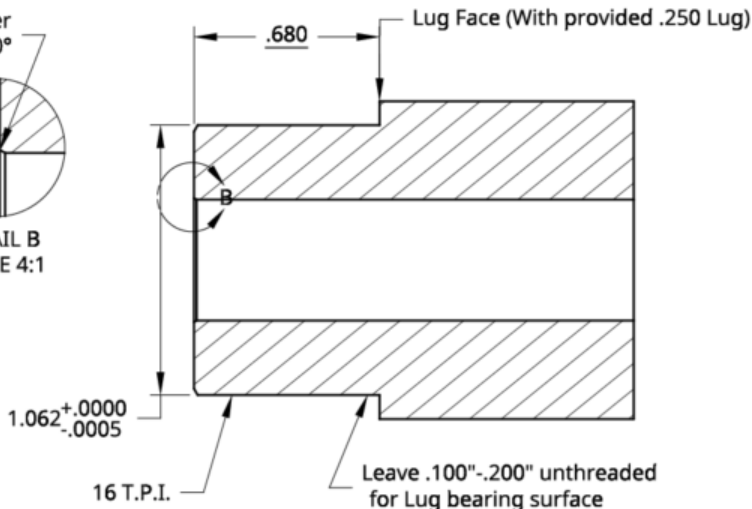

Bolt Face as drawn is .155" from end of tennon.

Tennon Length of 0.680" leaves 0.010" clearance from bolt nose to barrel face.

It is recommended to chamfer mouth of chamber to ease feeding. 0.010" depth with approx 30° angle is sufficient.

UNLESS OTHERWISE SPECIFIED,  
DIMENSIONS ARE IN INCHES  
XXX = ±.005 ANGULAR = ±°  
XXXX = ±.0005 FRACTIONAL = ±  
SURFACE FINISH ✓

DO NOT SCALE DRAWING

BREAK ALL SHARP EDGES AND  
REMOVE BURRS

THIRD ANGLE PROJECTION



NAME	DATE
DRAWN DN	5/17
CHECKED	
APPROVED	

MATERIAL	FINISH

Curtis Custom AXIOM Action Tennon

FOR REV C/D AXIOM

SIZE	DRWG NO.	REV
A		D-
SCALE	WEIGHT	SHEET
2:1		1 of 1